

PLANK

Gustafs Linear Planks lets you combine a beautiful linear design with the best possible fire rating. Using the famous Gustafs Capax installation system a perfect end result will be guaranteed as well the option to fully integrate the Planks with Gustafs Panels and Ribs. Every Plank comes with one unique and full crown veneer flitch for the most exclusive experience.

FIRE

The fiber gypsum core in the Planks is not only non combustible and gives the Planks a total rating of B-s1,d0 including the veneer, it also gives the Planks an absolute stable form and seamless perfection – forever!

ACOUSTICS

The Gustafs Linear Planks can also be perforated as a design element or to achieve a higher sound absorption value.

INSTALLATION

Using Capax profiles or clips, the Planks can be installed vertically, horizontally or diagonal and with closed or more eye catching coloured open joints between the Planks. Linear Planks are the perfect tool to create curved walls and ceilings.

INSTALLATION PROPOSALS

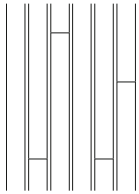

Decreasing lengths

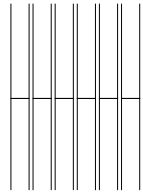

Full lengths

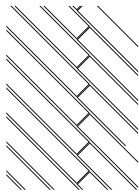

Diagonal

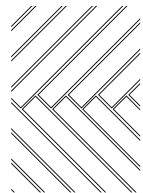

Fishbone

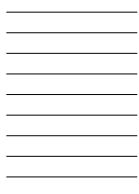

Weatherboard

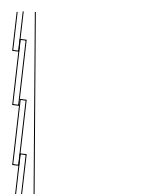

Weatherboard

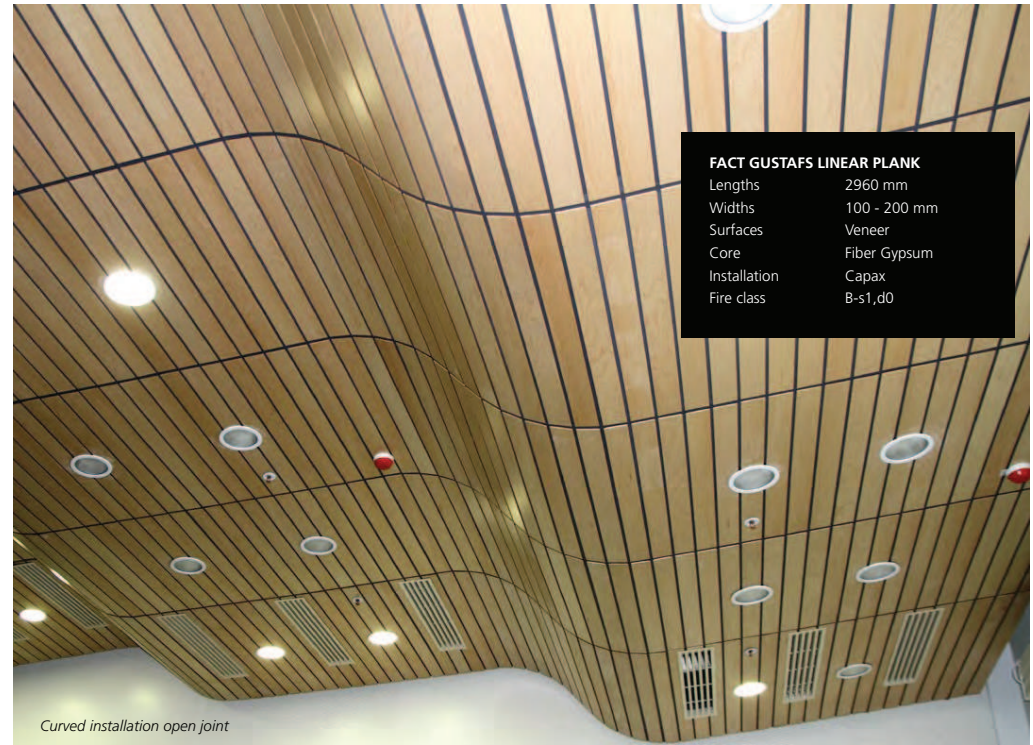
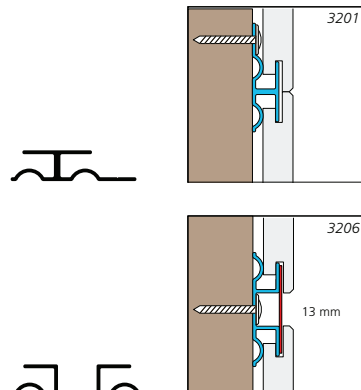

Curved installation open joint

FACT GUSTAFS LINEAR PLANK

| | |
|--------------|--------------|
| Lengths | 2960 mm |
| Widths | 100 - 200 mm |
| Surfaces | Veneer |
| Core | Fiber Gypsum |
| Installation | Capax |
| Fire class | B-s1,d0 |

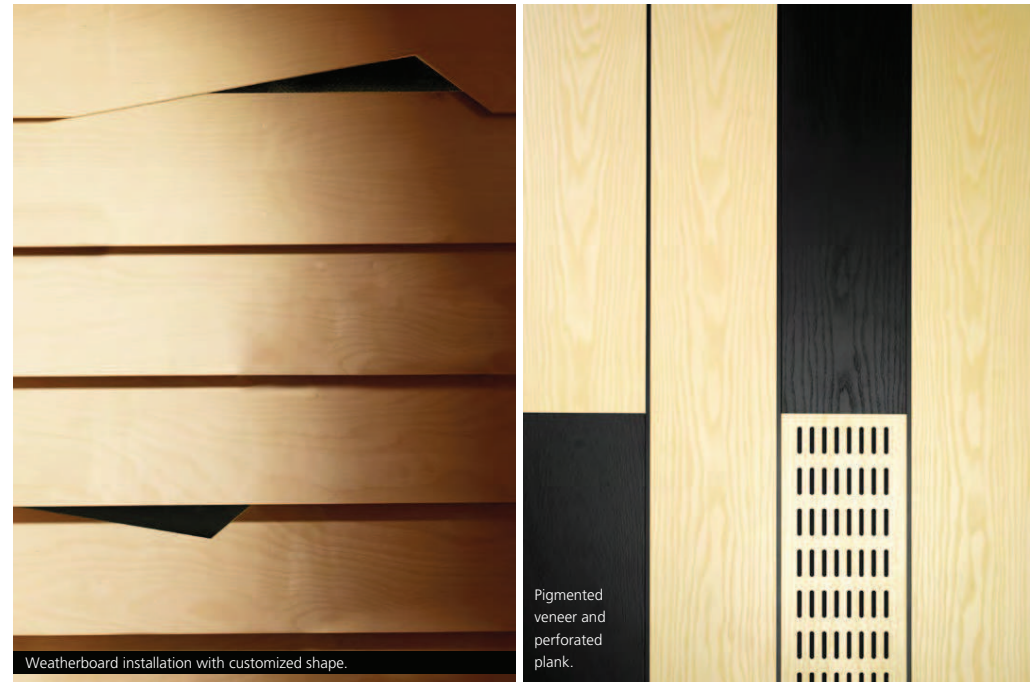

Weatherboard installation with customized shape.

Pigmented veneer and perforated plank.