

Gustafs Capax - Wall

INSTALLATION SYSTEM

PRODUCTS: Panel, Plank-P, Plank

APPLICATION: Wall

REV: 2024-02



GUSTAFS





Capax - wall panels



Capax is the name for our unique installation system with aluminium profiles for mounting wall and ceiling panels.

The system currently has several different solutions that meet both aesthetic and functional requirements. The variants of joints and connections are several.

Gustafs Panel System is fitted on to walls by means of Capax installation profiles so that each panel is individually locked on all four sides.

All Gustafs Capax profiles are manufactured in aluminium. The high precision and high torsional stiffness of the aluminium profiles results in a rigid and self-supporting system, which allows completely hidden and seamless installations.

AN INTEGRATED INSTALLATION SYSTEM

The Capax installation system is fully integral with the panels, concealed, time saving and reliable. The construction is torsionally rigid and self-bearing, lacking the need to fix onto adjacent walls.

Gustafs Capax System offers full panel demountability and thereby access to overlying technical installations while maintaining its overall stability and strength.



Our website is always up to date, all current information about Gustafs products can be found here » gustafs.com

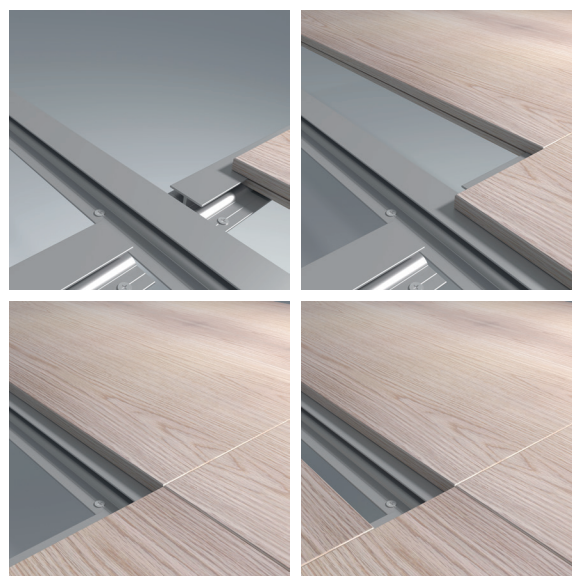



Capax mounting profiles for walls

START PROFILES

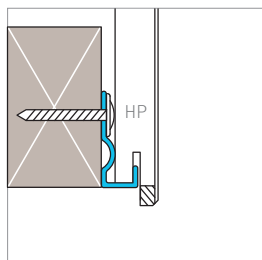

CAPAX 3200

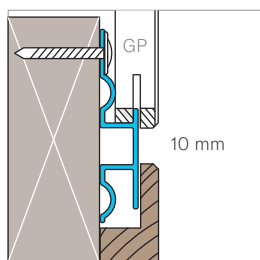

CAPAX 3202

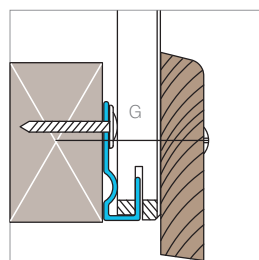

CAPAX 3203

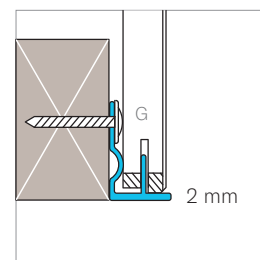

CAPAX 3207

END PROFILES

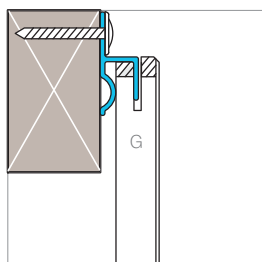

CAPAX 3204

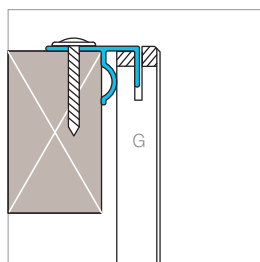

CAPAX 3205

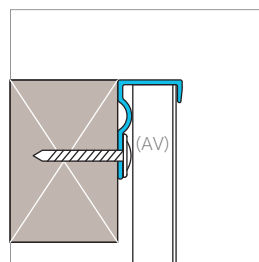

CAPAX 3251/3231 (HPL)

CLOSED JOINT PROFILES

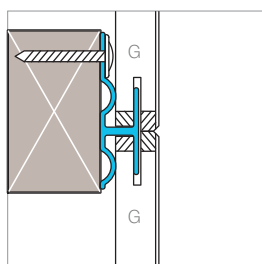

CAPAX 3201

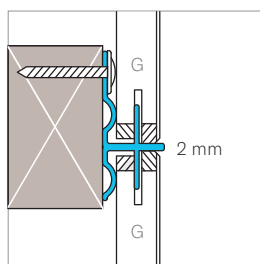

CAPAX 3208

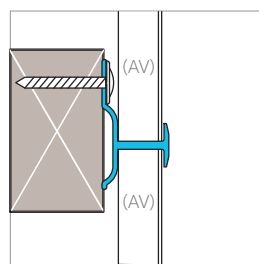

CAPAX 3217

OPEN JOINT PROFILES

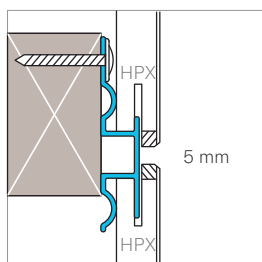

CAPAX 3202/
3212 (HPL) 5mm

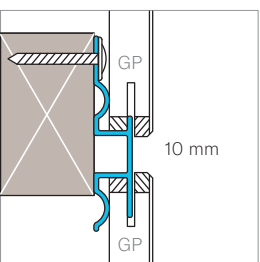

CAPAX 3202/
3212 (HPL) 10mm

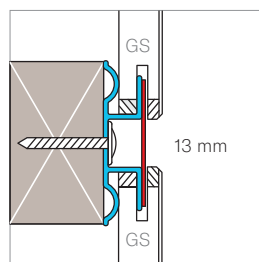

CAPAX 3206 13mm

SLATWALL

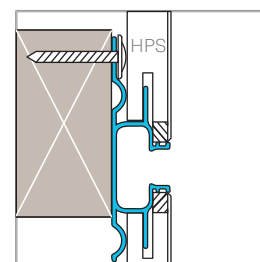

CAPAX 3266



Capax - Corner profiles

OUTER CORNER PROFILES

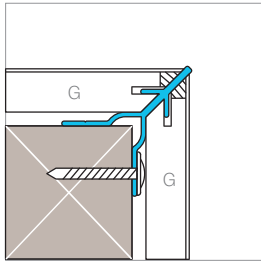

CAPAX 3209/3239 (HPL)

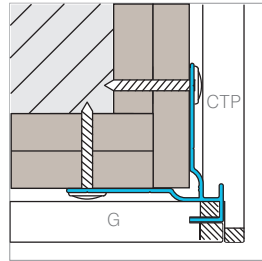

CAPAX 3215

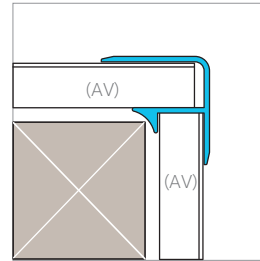

CAPAX 3218

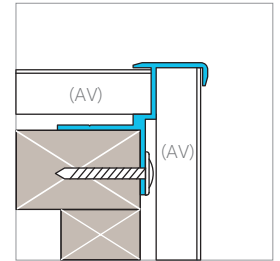

CAPAX 3219/3229 (HPL)

OUTER CORNER PROFILES

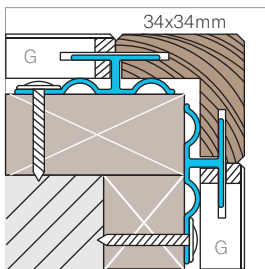

CAPAX 3201

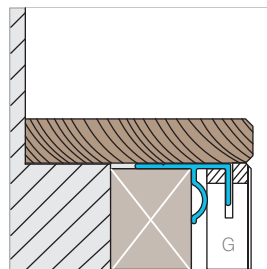

CAPAX 3205

OUTER CORNER

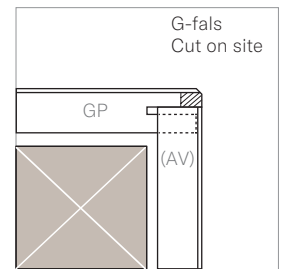
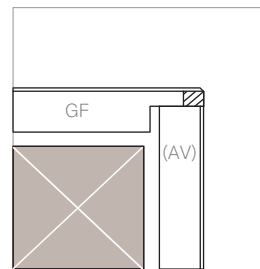

INNER CORNER PROFILES

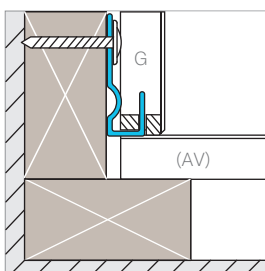

CAPAX 3203

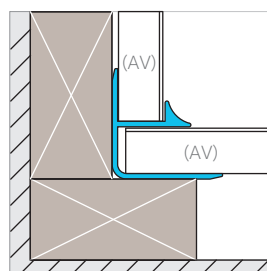

CAPAX 3218

CORNER PROFILES



CAPAX 3209



CAPAX 3218



CAPAX 3219



Capax - Demountable panels & solid wooden profiles

DEMOUNTABLE START PROFILES

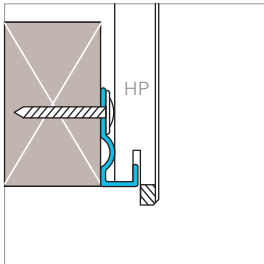

CAPAX 3200

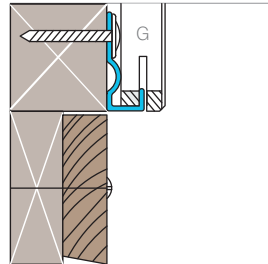

CAPAX 3200

DEMOUNTABLE JOINT PROFILES

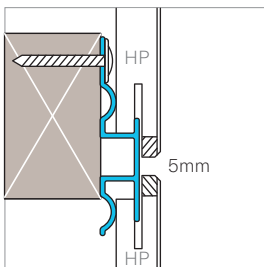

CAPAX 3202 5mm

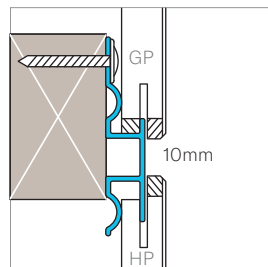

CAPAX 3202 10mm

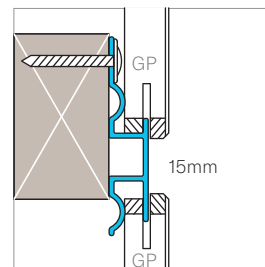

CAPAX 3202 15mm

DEMOUNTABLE END PROFILES

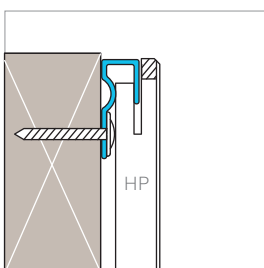

CAPAX 3203

SOLID WOODEN PROFILES

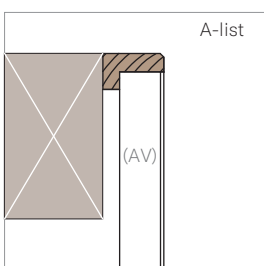

A-EDGE COVER 18x10mm

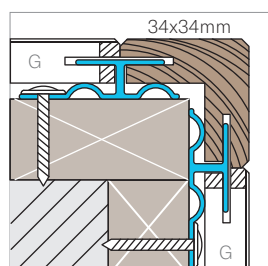

CORNER PROFILE 34x34mm

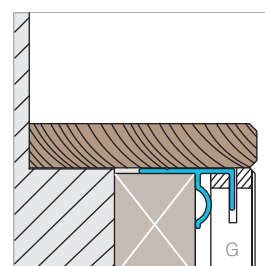

COVER PROFILE 140x16mm

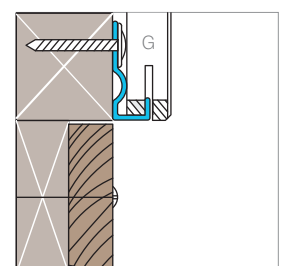

PLINTH 100x16mm



Technical drawings - Wall constructions

ACOUSTIC CONSTRUCTION 38mm

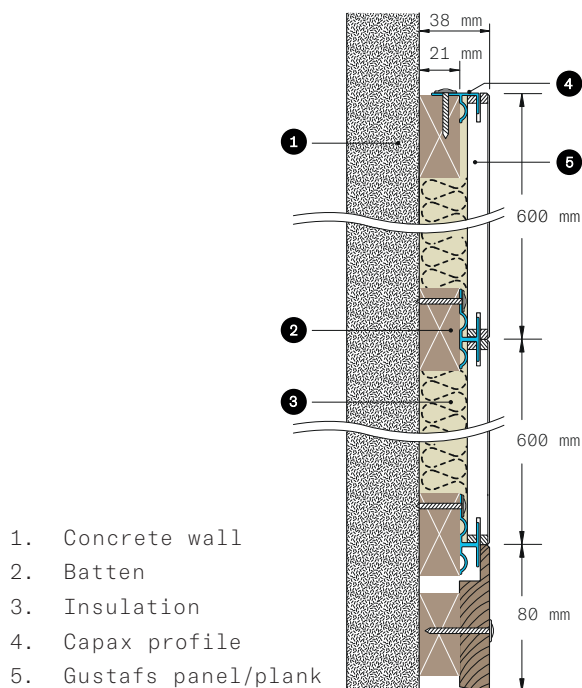

ACOUSTIC CONSTRUCTION 88mm

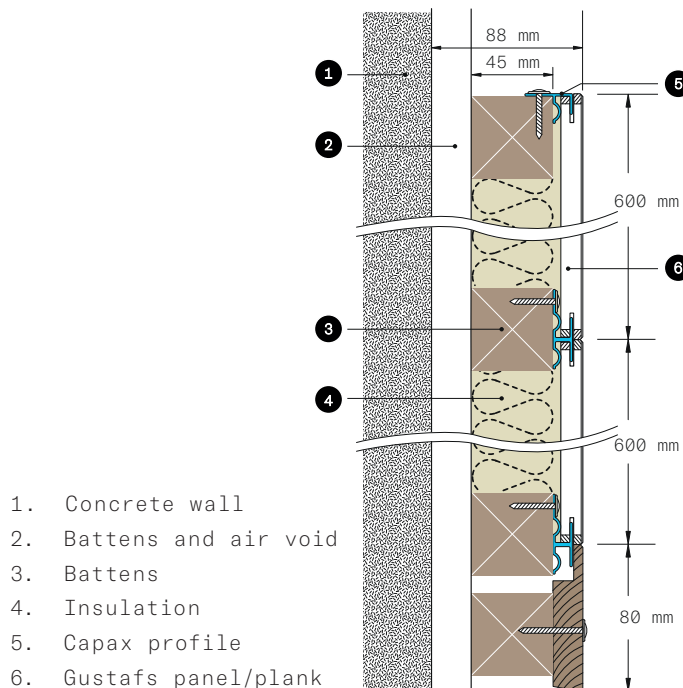

PARTITION WALL CONSTRUCTION 17+24mm

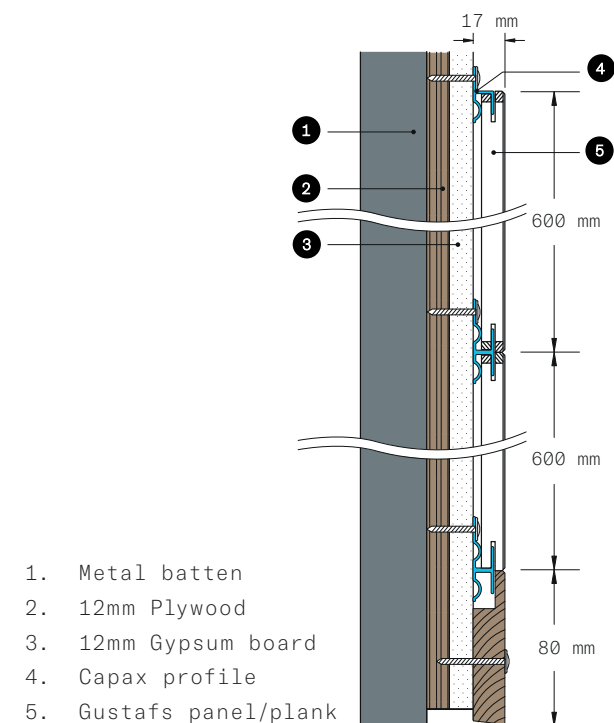

WALL ASSEMBLY 29+24mm

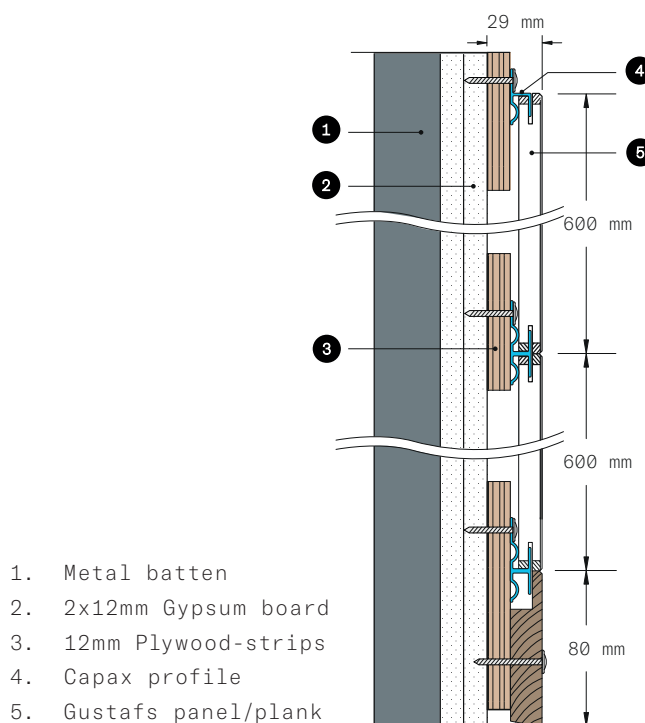

INSTALLATION SYSTEM

PRODUCTS: Panel, Plank-P, Plank

APPLICATION: Wall



Inspirational projects

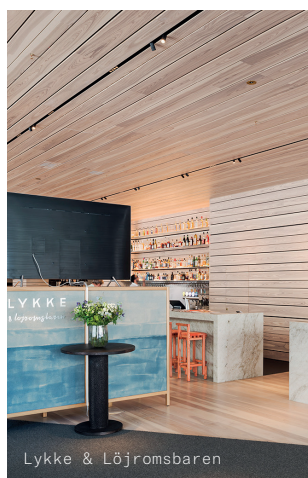
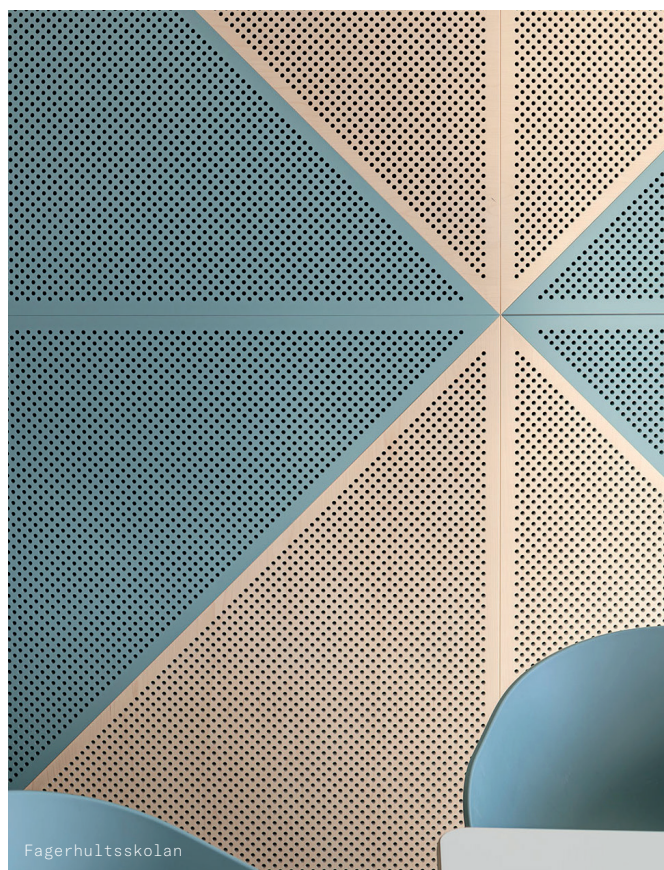

gustafs.com | [projects](#)

Gustafs Scandinavia AB
Stationsvägen 1
SE-781 60
Gustafs, Sweden

Tel: +46 (0)243 79 20 20
Email: supportexport@gustafs.com
www.gustafs.com

GUSTAFS
DESIGNED FOR EYES AND EARS