

CEILINGS

## INSTALLATION GUIDE

# Galaxy

The Galaxy is a striking round element composed of vertical tiles, featuring a unique striped look, and offering different heights or thicknesses for the baffles. It can be installed as a floating element or securely screwed close to an existing ceiling, providing versatile design possibilities.

THICKNESS

12 mm

24 mm

HIEGHT

10 cm

20 cm

MAX LENGTH

15 cm

130 cm

## DIMENSIONS

---

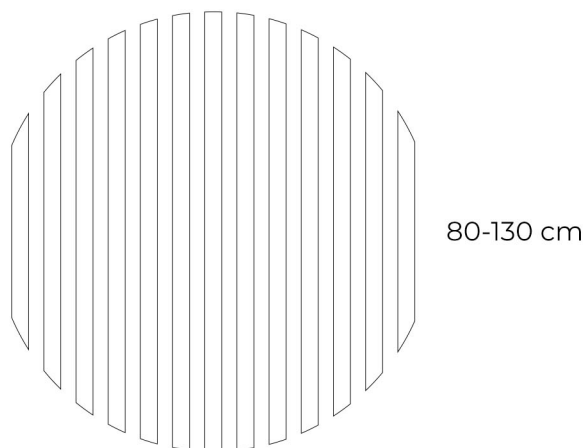

## ISOMETRY

---

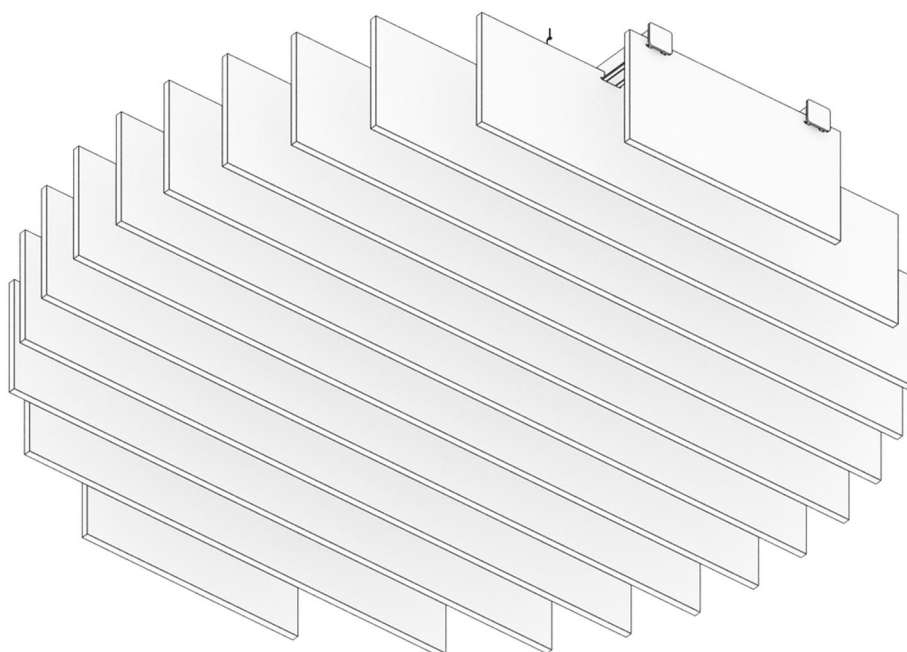

INSTRUCTIONS

# These are your parts.

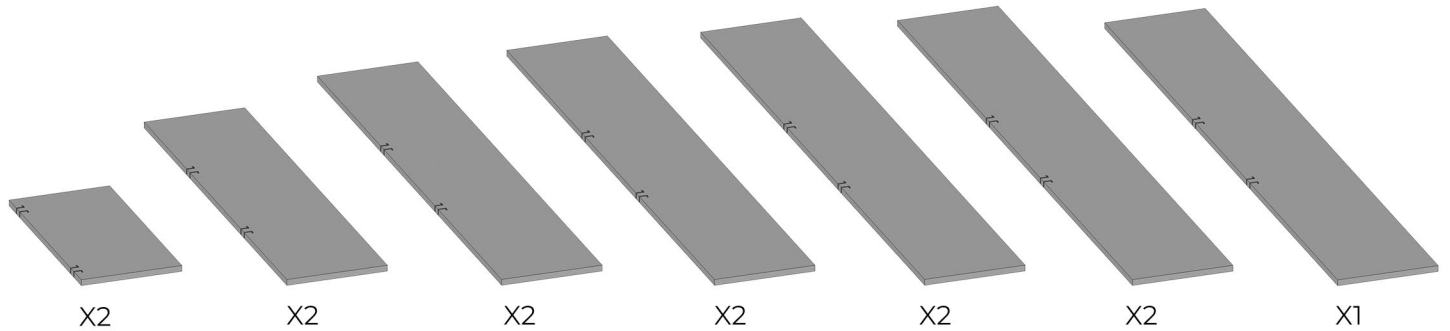

**Different sized Beams**  
Dismountable Tile

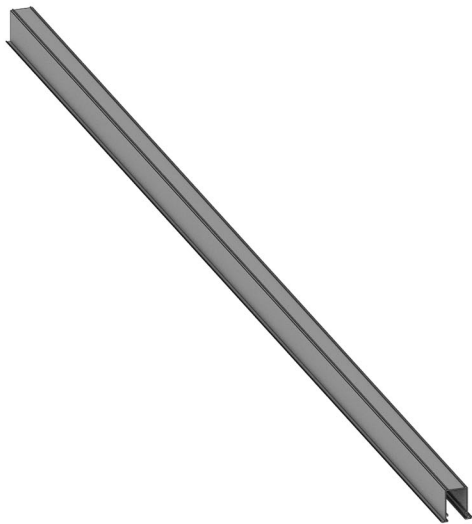

**U Shaped Profile**  
Dismountable Tile

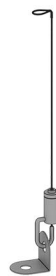

**Dedicated Cable  
Hanging Accessory**



**End Caps**  
Dismountable Tile

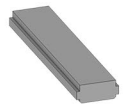

**Spacers**  
Dismountable Tile

#### TYPE A (Uniformed Hanging)

---

- ① **Mark the hanging points on the above ceiling. Make sure to keep a distance between the two rows similar to the one appears between the two slots on the baffles.**

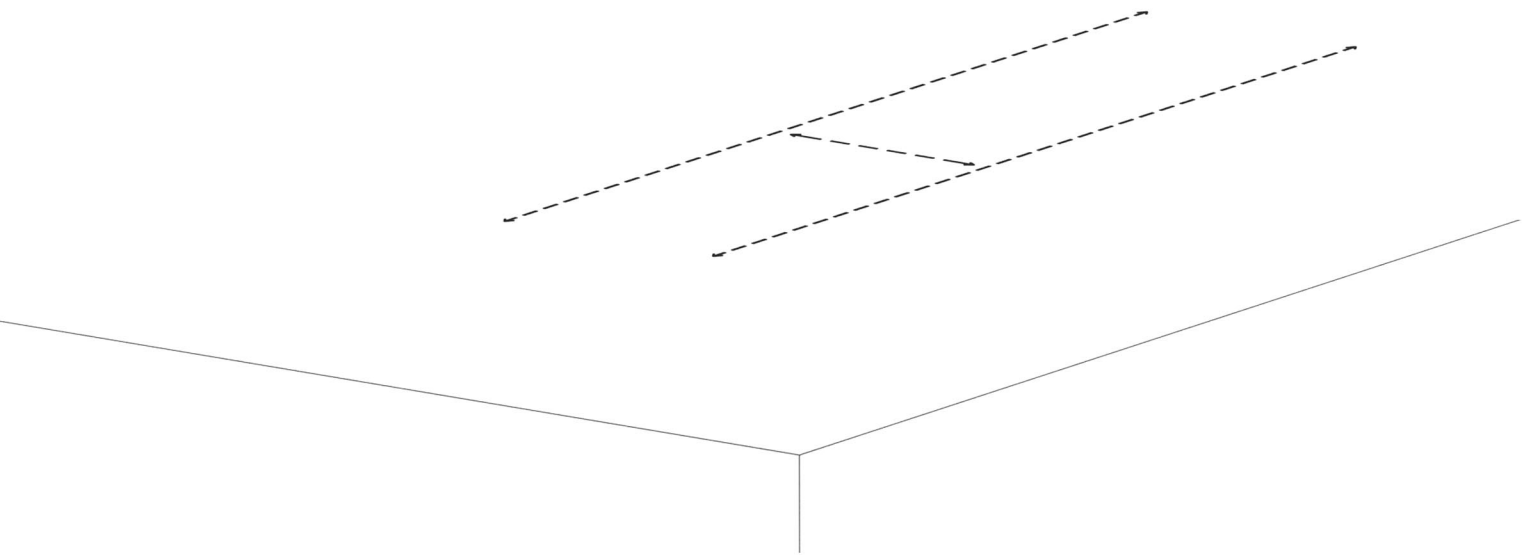

- ② **Install the adjustable hangers accordingly, keep distance of 80-120cm between two hangers on the same row.**

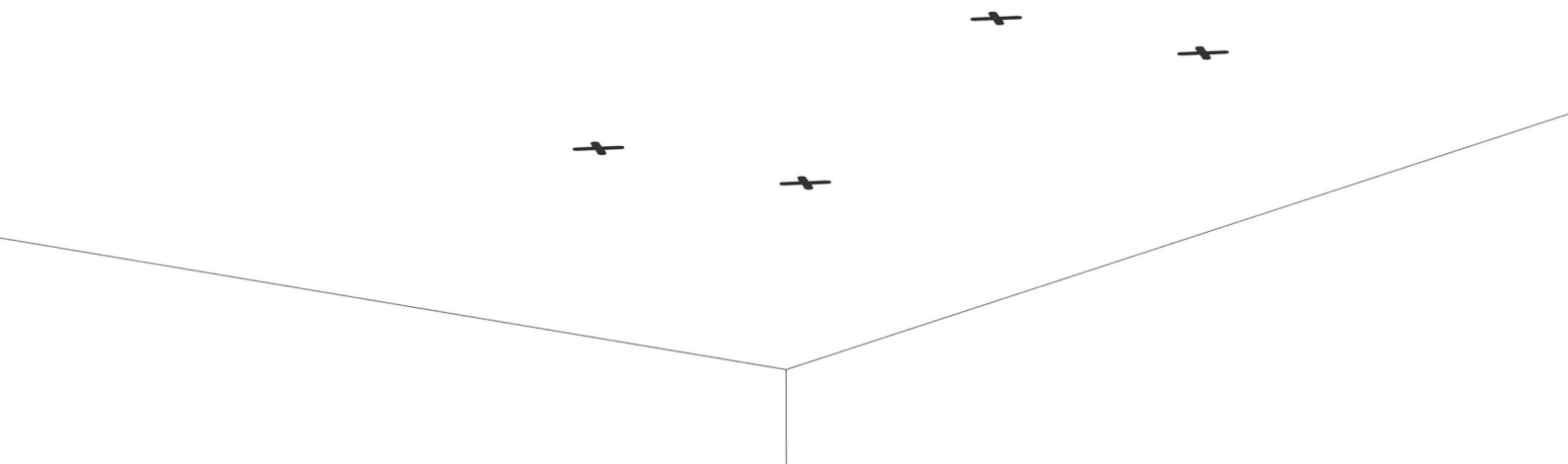

- ③ **Screw the cables into the marks on the ceiling**

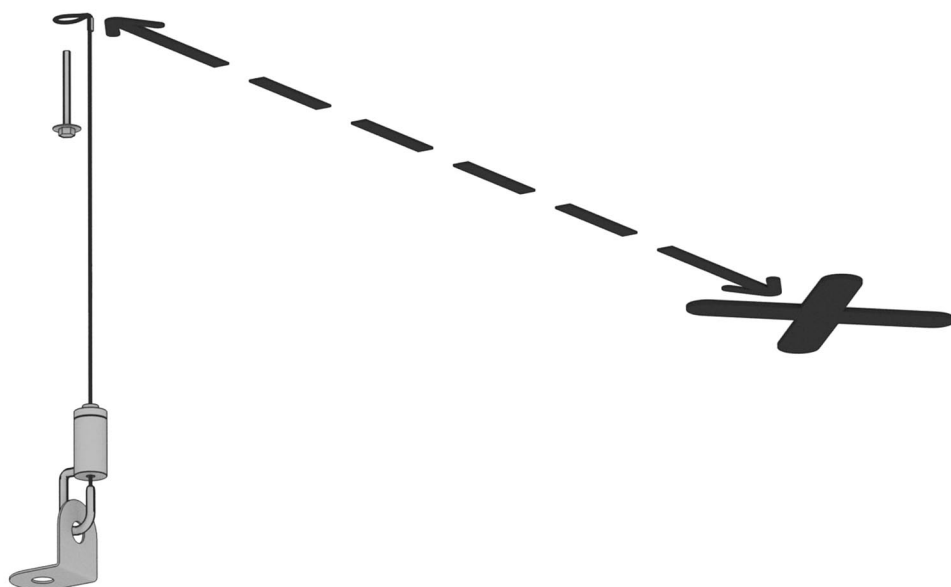

- ④ **Make sure that the two profiles are parallel to each other and installed**

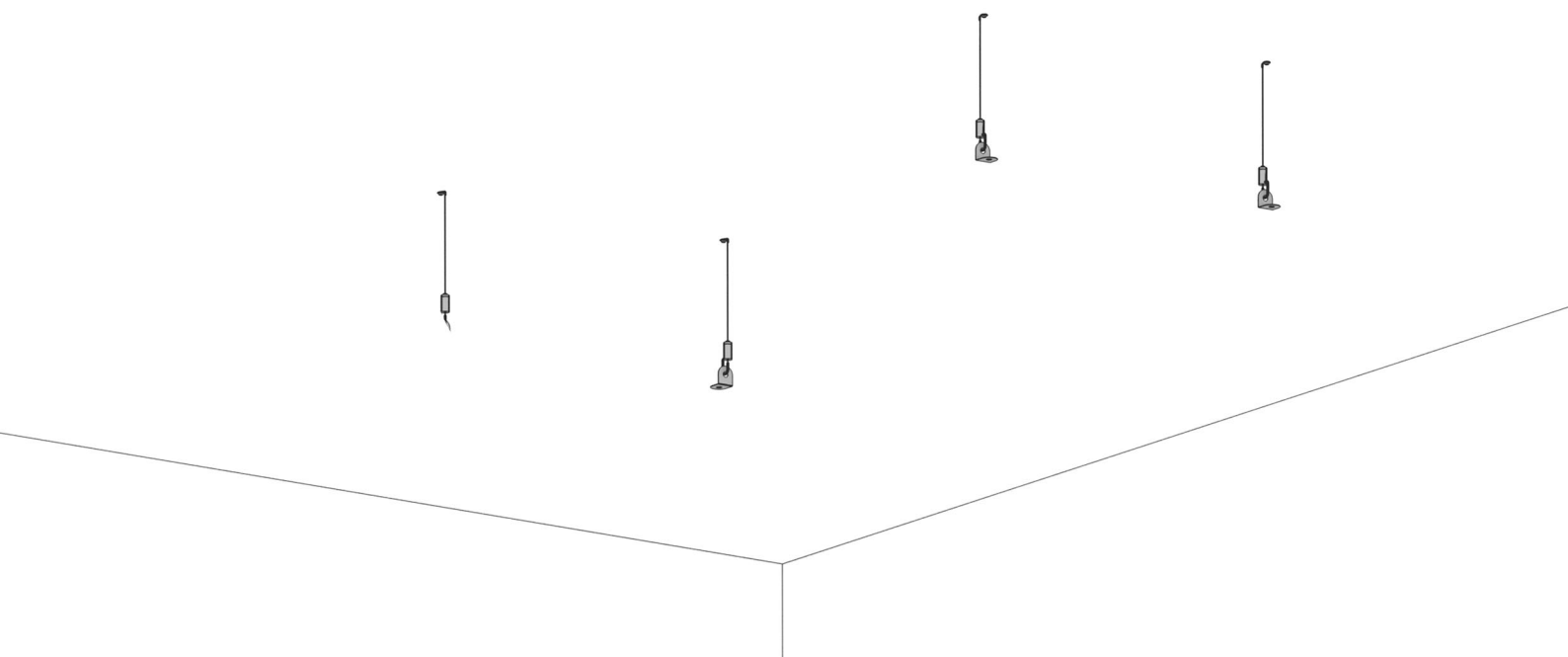

5 **Thread the screw into the U Profile.**

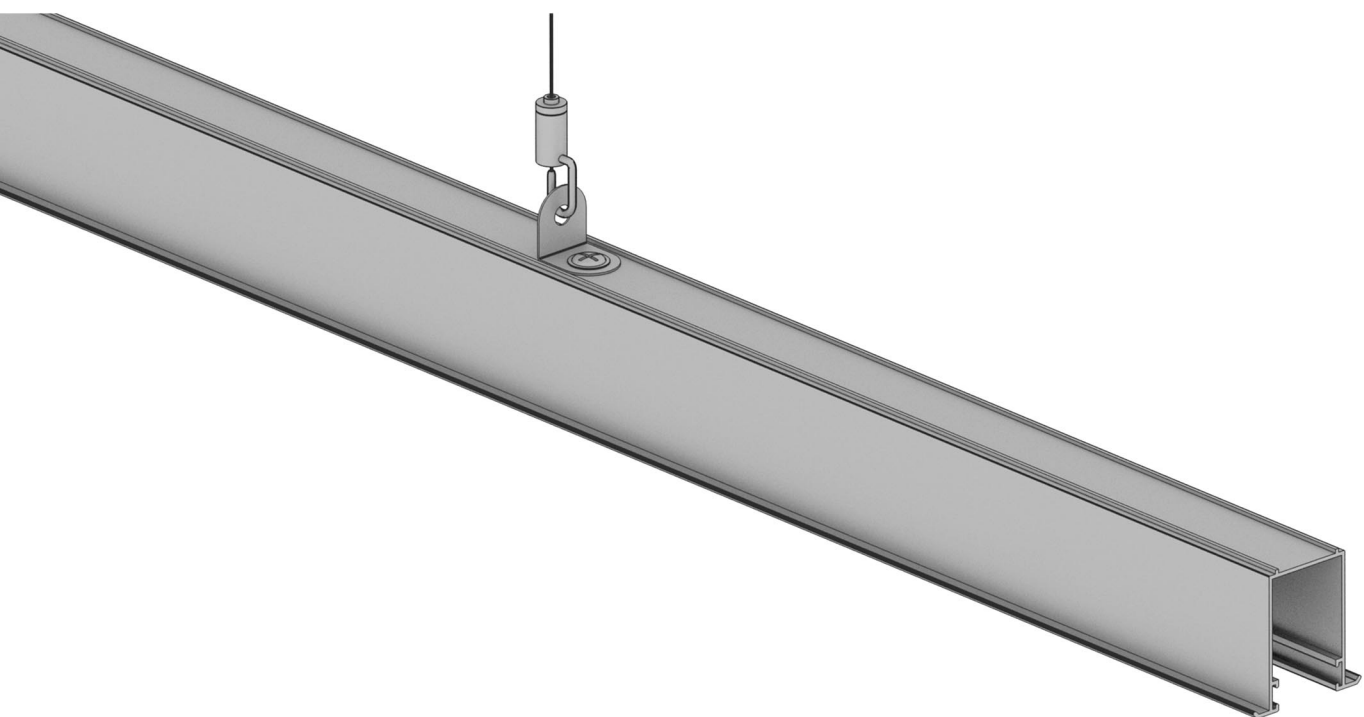
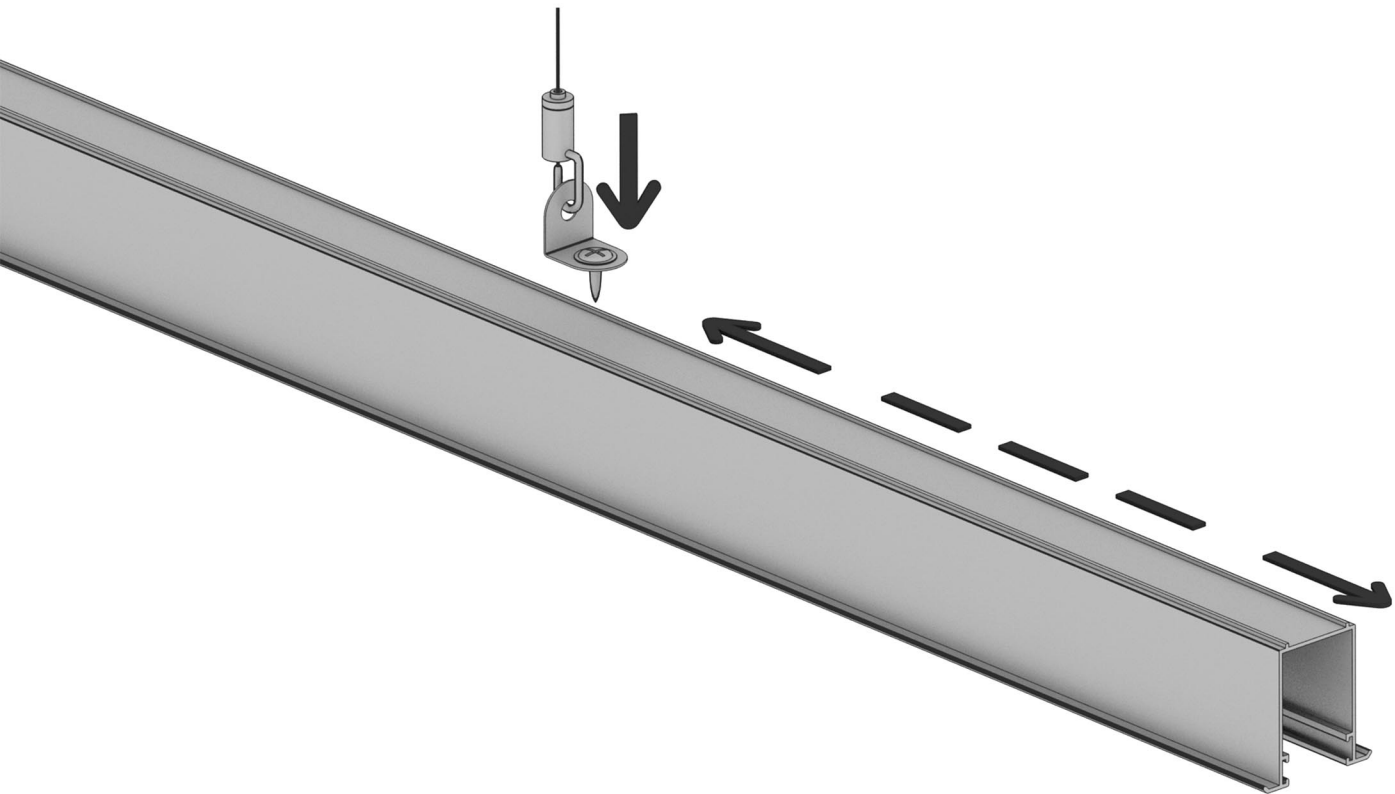

- ⑦ **Make sure that the two profiles are parallel to each other and installed exactly opposite each other.**

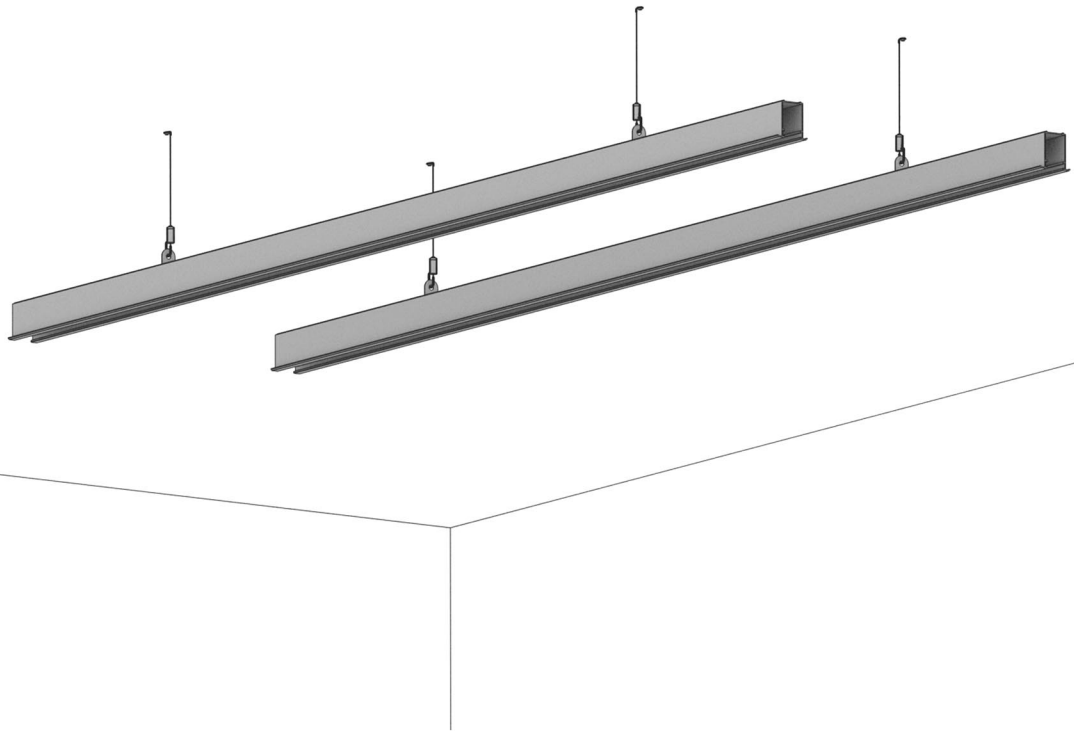

- ⑧ **Slide the baffle into the U profiles, using the slots**

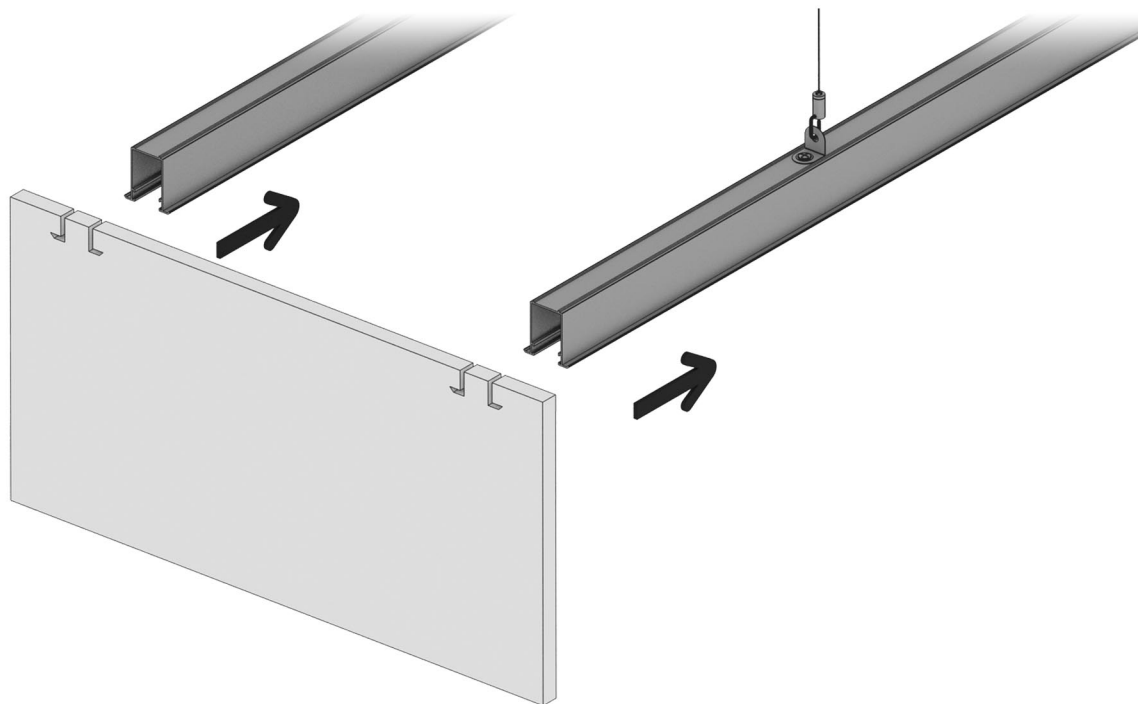

- ⑨ **Install the baffle by size, smallest to largest and then backwards.**

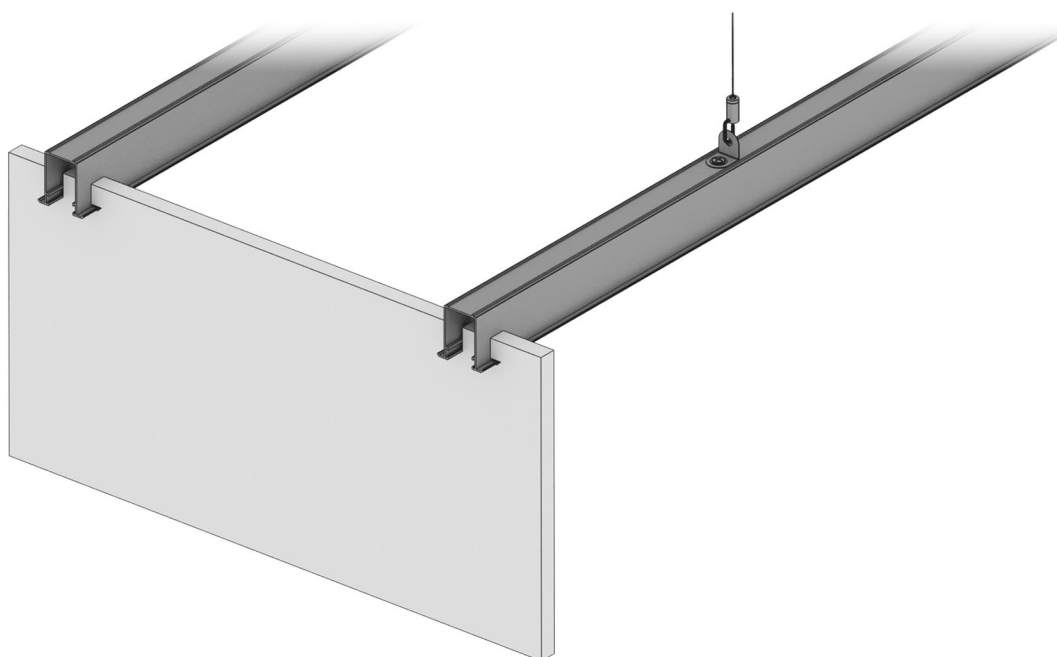



- ⑩ **between each baffle slide a spacer in order to maintain perfect gaps**

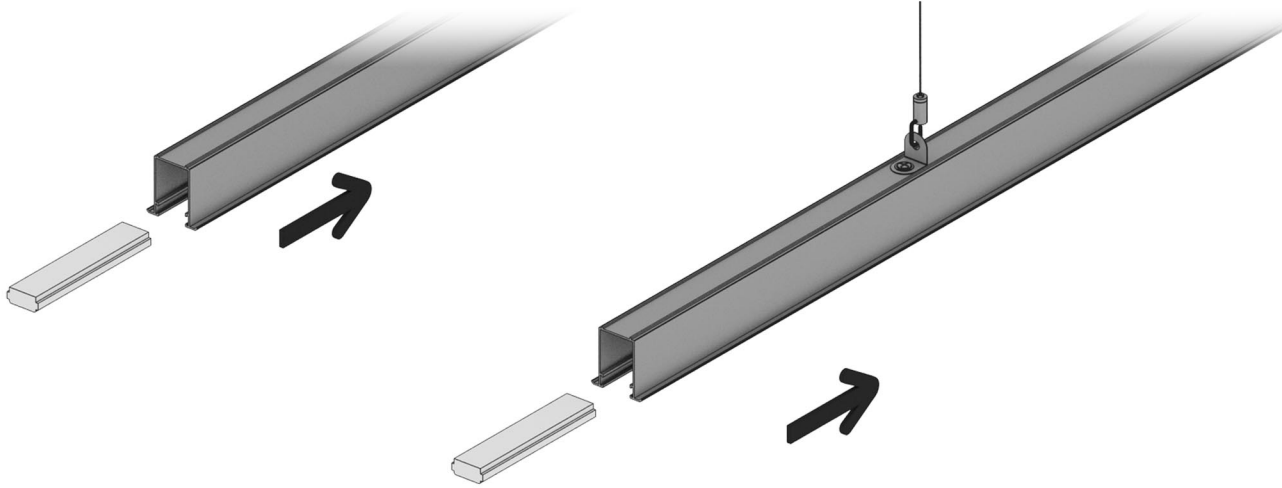

- ⑪ **Make sure the spacers are placed all the way back up against the previous baffle**

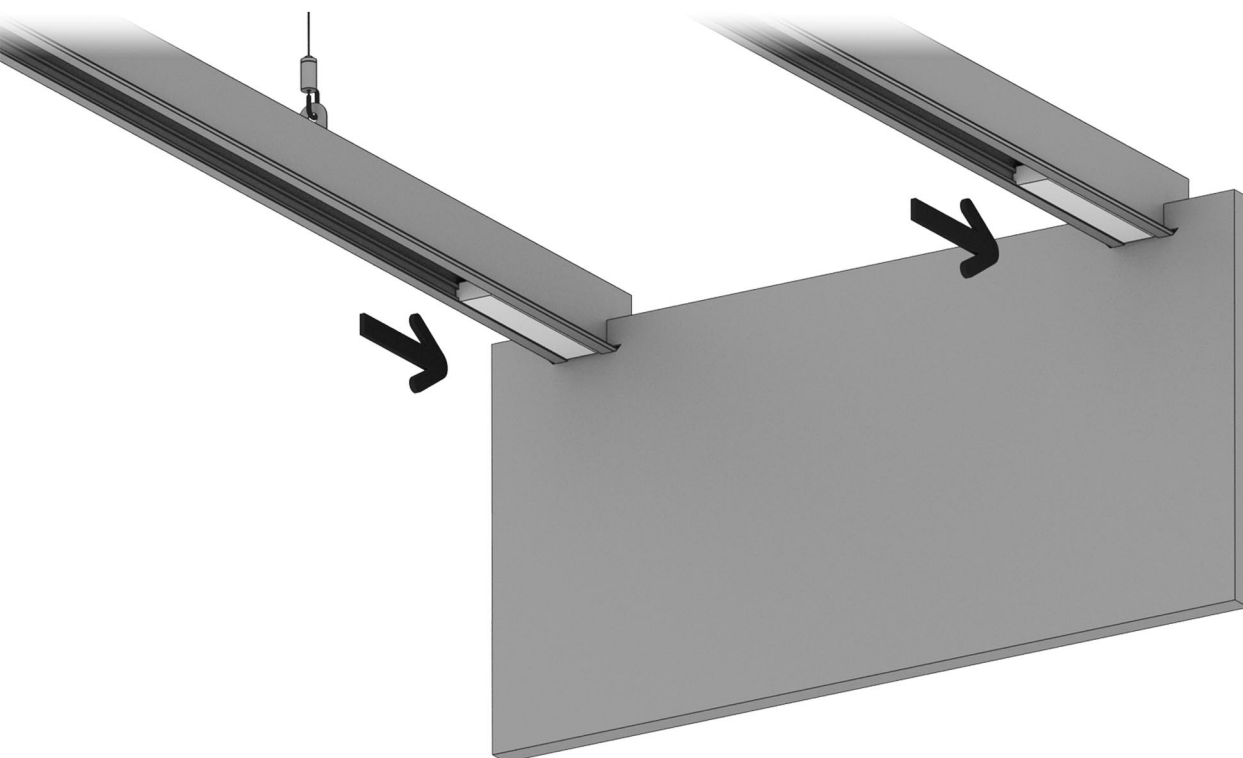

- 12 **After sliding all the baffles and spacers into place put on the end caps and glue them to lock everything in place**

